

A person wearing a black wetsuit and a blue and yellow swim cap stands on a sandy beach at sunset. Their arms are outstretched horizontally, pointing towards the horizon. The person has a prosthetic leg on their right side. The background shows the ocean and a bright, hazy sky.

SIMONA

SIMONA® SIMOLIFE

Product Range for Orthotics and Prosthetics

GLOBAL THERMOPLASTIC SOLUTIONS

Key

Fields of application



Trunk orthoses



Orthoses for upper
extremities



Orthoses for lower
extremities



Foot/leg prostheses



Hand/arm
prostheses

Contents

SIMONA – System Meets Safety

Plastics in Service of Health	3
Global Thermoplastic Solutions	4
Diversity of Materials	6

Applications

The Right Material for Each Application	8
Your Benefits at a Glance	10
Processing Example: Lower Arm Orthosis	12
Processing Example: Interior Prosthetic Socket	14

Product Overview

SIMONA® SIMOLIFE PE-HWV	16
SIMONA® SIMOLIFE PE 1000	17
SIMONA® SIMOLIFE PE-W	18
SIMONA® SIMOLIFE PP-DWV	19
SIMONA® SIMOLIFE PP-C	20
SIMONA® SIMOLIFE PETG	21
SIMONA® SIMOLIFE EVA flex	22
SIMONA® SIMOLIFE EVA superflex	23

Services

Advice and Information	24
SIMONA worldwide	26

Plastics in Service of Health SIMONA – A Trusted Partner



Acknowledged for its consistently high quality, SIMONA has been a trusted partner to the orthopaedic technology sector for more than 35 years. The SIMONA® SIMOLIFE line of sheet materials represents the most extensive range of products tailored to the specific requirements of the orthopaedics industry. Using certified raw materials, we manufacture premium-quality products that meet the highest standards applicable within the health care sector.

Global Thermoplastic Solutions – Welcome to SIMONA

SIMONA is acknowledged as one of the leading producers and development partners in the field of thermoplastics. We are able to offer you best-in-class solutions tailored to your applications: in the chemical processing industry, in the water, energy and commodities supply sector as well as in the field of mobility, construction and environmental technology. What is more, our operations span the globe.

Drawing on our outstanding abilities in process engineering, we specialise in the production of plastic sheets, fittings and piping systems designed to meet the highest standards. Our ambition is to become your first port of call for all safety- and eco-specific applications.

Extensive product range

SIMONA boasts one of the world's largest portfolios of thermoplastic products:

- Sheets
- Finished parts and profiles
- Welding rods
- Solid and hollow rods
- Pipes and fittings
- Valves

We use a wide selection of premium-quality materials to manufacture our products. Working in close cooperation with your team, we are also able to modify existing

materials or develop entirely new solutions for the purpose of creating customised products that meet your specific requirements.

Best-in-class quality

Frequent product audits and endurance testing provide essential data for our R&D engineers to make targeted improvements to the SIMONA portfolio on a continual basis. Committed to excellence, we are thus able to offer an innovative, high-quality product range.

Expert advice

As a customer, you always take centre stage: from project development and materials procurement through to production and on-site planning, we are committed to providing the very best professional advice and assistance. At the same time, we are inspired and spurred on by new technical challenges.

Global distribution network

SIMONA operates production plants in Europe, America and Asia. Maintaining a global network of subsidiaries and distribution partners, we are renowned for providing a fast, flexible and reliable service.

Compelling solutions

SIMONA City is designed to capture the spirit of diversity that infuses our portfolio of products. Discover SIMONA City!





The management systems operated by SIMONA AG with regard to quality, the environment and energy resources are certified in accordance with DIN EN ISO 9001, DIN EN ISO 14001 and DIN EN ISO 50001.



The quality management system of SIMONA AG in compliance with the Pressure Equipment Directive is certified to 97/23/EC Annex I, para. 4.3.

SIMONA® SIMOLIFE

Diversity of Materials

Thermoplastics have been instrumental in the evolution of modern-day orthopaedic technology and are now an integral part of this area of application. Today, they have almost completely replaced classic materials such as wood and leather.

The range of plastics to choose from is extensive, with polyethylene, polypropylene, ethylene-vinyl acetate, copolyester, etc. being used as compact sheet materials.

Specially developed for the field of orthopaedic technology, the SIMONA® SIMOLIFE line includes a wide range of products spanning various materials.

The various types of polymer used within this area display different characteristics. Thus, the demands of orthopaedic technicians with regard to specific production methods can be met in full, as can the personal requirements of each patient.

Plastics are generally acknowledged for their lightweight, skin-friendly properties, as well as offering the benefit of long-lasting functionality. Thanks to the high dimensional stability and efficient processability of the sheet materials, orthopaedic technicians can create orthoses and prostheses that are perfectly adapted to the patient's anatomy.

Each type of plastic offers specific benefits within its defined fields of application.

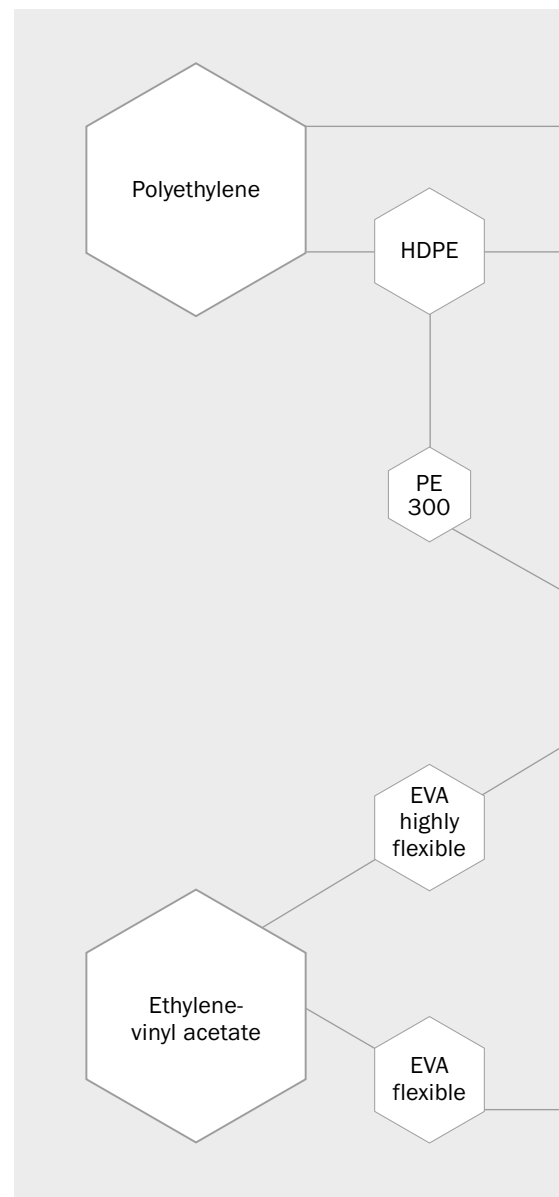

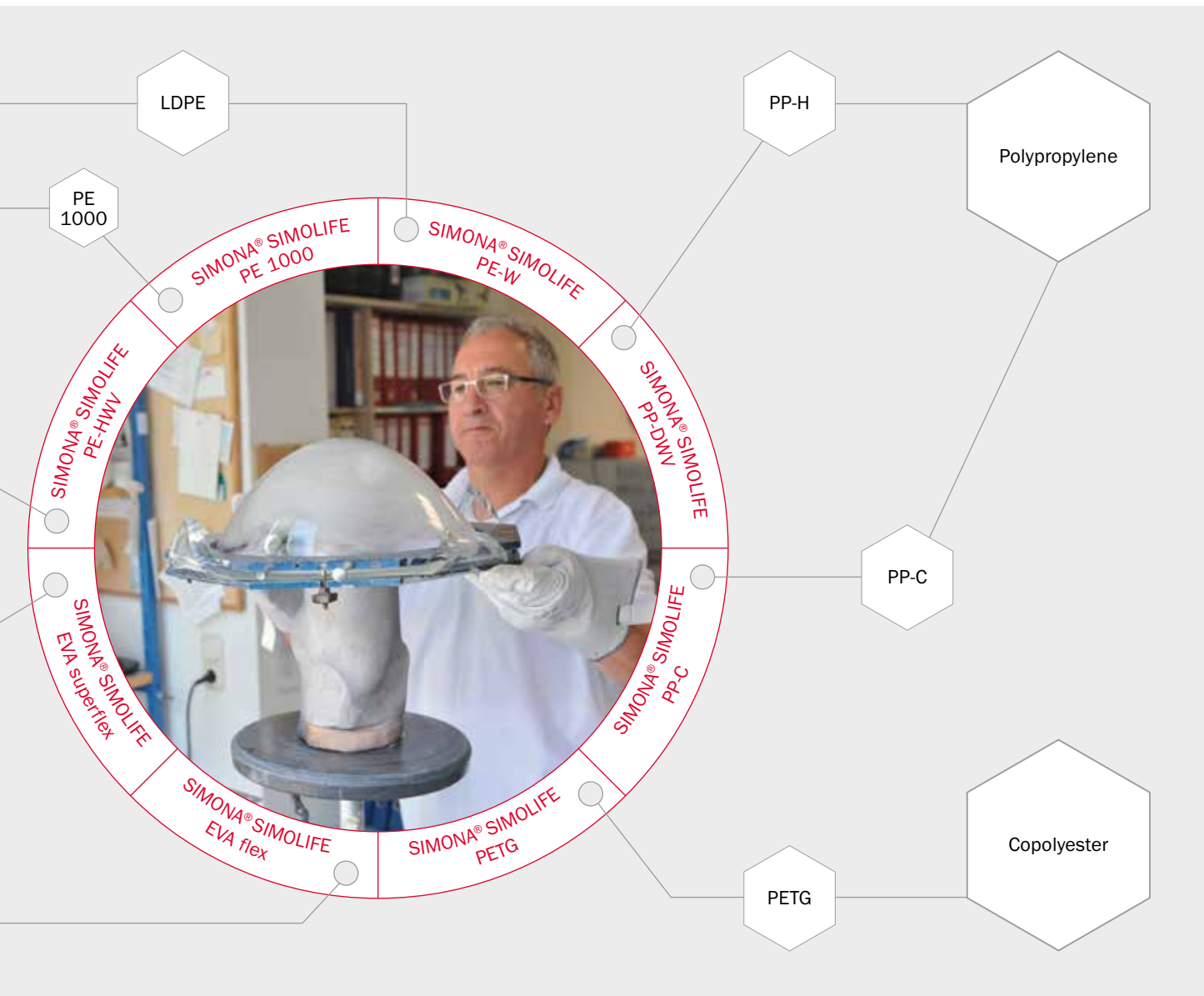

From polymer category to product range

SIMONA® SIMOLIFE

The Right Material for Each Application

	Diagnosis/test sockets	Final prosthetic sockets	Flexible interior prosthetic sockets
			
SIMONA® SIMOLIFE PE-HWV		✓	
SIMONA® SIMOLIFE PE 1000			
SIMONA® SIMOLIFE PE-W			✓
SIMONA® SIMOLIFE PP-DWV		✓	
SIMONA® SIMOLIFE PP-C		✓	
SIMONA® SIMOLIFE PETG	✓		
SIMONA® SIMOLIFE EVA			✓

Foot/leg orthoses (AFO, DAFO, KAFO)	Functional foot orthoses (FFO)	Hand/arm orthoses (HO)	Corsets
			
✓	✓	✓	✓
✓	✓		
✓	✓	✓	✓
✓	✓		✓
✓	✓	✓	✓
	✓		

SIMONA® SIMOLIFE

Your Benefits at a Glance



More than 35 years' experience

Acknowledged for the consistently high quality of its products, SIMONA has been a trusted partner to the orthopaedic technology sector for many years. Frequent product audits and endurance testing provide essential data for our R&D engineers to make targeted improvements to the SIMONA portfolio on a continual basis. Committed to excellence, we are thus able to offer an innovative, high-quality product range.

Highest quality standards

We only use certified raw materials of the highest quality for the

manufacture of SIMOLIFE products. The purity of these raw materials is safeguarded by stringent incoming goods inspections. Continuous quality monitoring during the production process and low-stress sheet extrusion help to guarantee consistent material properties for subsequent use in your field of application.

Excellent processing characteristics

SIMONA® SIMOLIFE products have excellent thermoforming properties. With the help of advanced process engineering, we have reduced the level of material shrink-

age to a minimum – a tangible benefit particularly in the field of orthopaedic technology. This translates into excellent dimensional stability and best possible fit.

Very good skin compatibility

All SIMOLIFE products are physiologically safe as per BfR, EU and FDA and are certified as biocompatible in accordance with DIN EN ISO 10993-5/-10. As a result of these certified properties and the resistance to sweat, cosmetics, skin creams, detergents and disinfectants, they offer users the combined benefits of safety and reliability.

Product Range

		SIMONA® SIMOLIFE PE-HWV	SIMONA® SIMOLIFE PE 1000	SIMONA® SIMOLIFE PE-W	SIMONA® SIMOLIFE PP-DWV	SIMONA® SIMOLIFE PP-C	SIMONA® SIMOLIFE PETG	SIMONA® SIMOLIFE EVA flex	SIMONA® SIMOLIFE EVA superflex
Sheets (sizes/thicknesses in mm)									
	400 x 400						9, 10, 12 , 15 , 20	3, 4, 6, 8, 9 , 10 , 12 , 15	6, 9, 10 , 12 , 15
	1,208 x 804						8, 9, 10, 12 , 15 , 20		
	2,000 x 1,000	2, 3, 4, 5, 6 , 8 , 10	1, 2, 3, 4, 5, 6	1 , 1.5, 2, 3, 4 , 5 , 6	2, 3, 4, 5, 6	2, 3, 4, 5, 6		3, 4, 6, 8, 9, 10, 12, 15	
	50,000 x 1,000			1, 1.5, 2					
	Colours	natural, skin-coloured	natural, black, green	natural	natural	natural	transparent	natural, skin-coloured	natural
	Antibacterial properties on request	✓	-	-	✓	-	✓	✓	-

Bold type = available immediately (colour: natural or transparent); light-faced type = available on request
The sizes specified are standard sizes. Other sizes, thicknesses and colours available on request.

Material specifications

	SIMONA® SIMOLIFE PE-HWV	SIMONA® SIMOLIFE PE 1000	SIMONA® SIMOLIFE PE-W	SIMONA® SIMOLIFE PP-DWV	SIMONA® SIMOLIFE PP-C	SIMONA® SIMOLIFE PETG	SIMONA® SIMOLIFE EVA flex	SIMONA® SIMOLIFE EVA superflex
Density, g/cm ³ , DIN EN ISO 1183	0.947	0.930	0.928	0.905	0.910	1.270	0.934	0.955
Tensile modulus of elasticity, MPa, DIN EN ISO 527	900	700	350	1,380	1,200	1,900	75	19
Shore hardness D, DIN EN ISO 868	64	60	54	70	67	78	39	29
Processing temperature, °C (oven temperature)*	165 – 180	190 – 215	120 – 130	185 – 215	185 – 215	160 – 170	150 – 160	150 – 160
Heat-up time, min/mm sheet thickness (retention time in oven)*	2 – 3	3 – 4	2 – 3	2 – 3	2 – 3	3 – 4	1 – 2	1 – 2
Biocompatibility in accordance with DIN EN ISO 10993-5/-10	✓	✓	✓	✓	✓	✓	✓	✓
Physiological safety in accordance with BfR, EU and FDA	✓	✓	✓	✓	✓	✓	✓	✓

* The actual parameters can vary depending on the type and condition of the oven as well as the sheet thickness.
Therefore, all figures presented here are for orientation purposes only. The exact parameters will have to be determined by the user.

SIMONA® SIMOLIFE PE-HWV

Processing Example: Lower Arm Orthosis



1 Preparing a plaster cast (negative cast)

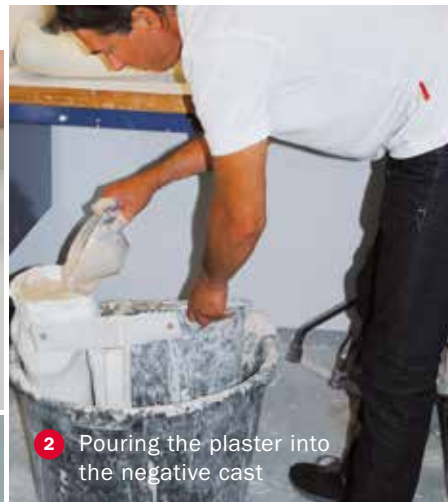

2 Pouring the plaster into the negative cast



3 Shaping and measuring the plaster model (positive model)

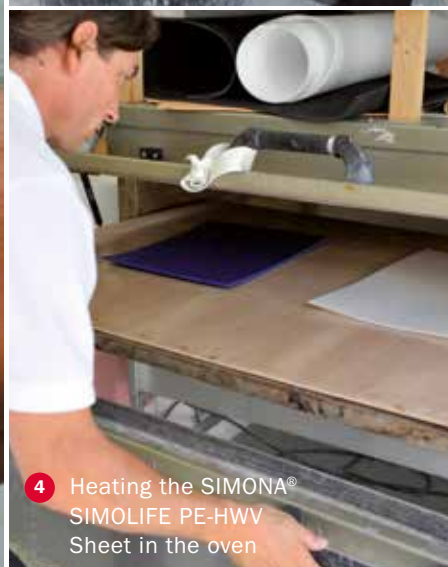

4 Heating the SIMONA® SIMOLIFE PE-HWV Sheet in the oven



5 Colouring the sheet with thermal colouration paper



6 Deep-drawing the heated sheet over the plaster model by means of vacuum forming



7 Cutting and removing the lower arm orthosis



8 Unmachined lower arm orthosis



9 Aligning and reworking the lower arm orthosis



10 Fitting the finished lower arm orthosis

SIMONA® SIMOLIFE EVA

Processing Example: Interior Prosthetic Socket

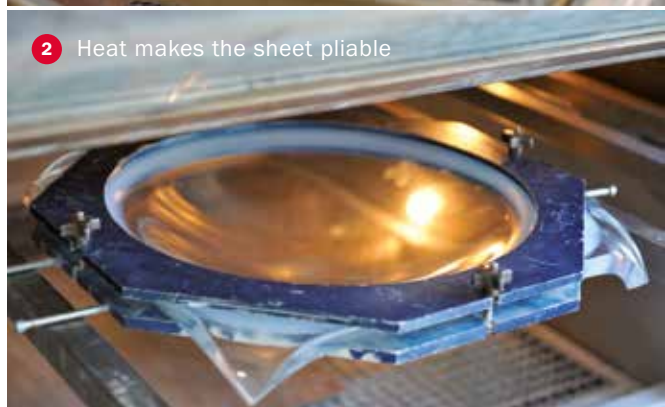



With the kind assistance of the medical supply store
“Sanitätshaus Guckes” in Worms.

SIMONA® SIMOLIFE PE-HWV



SIMONA® SIMOLIFE PE-HWV

Fields of application	Description	Properties	Certifications
	High-density polyethylene (HDPE)	Superior to LDPE in rigidity and strength	Biocompatibility in accordance with DIN EN ISO 10993-5 and DIN EN ISO 10993-10
		Minimal, calculable shrinkage	Physiological safety in accordance with BfR, EU and FDA
		Resistant to sweat, cosmetics, skin creams, detergents and disinfectants	

Material specifications

Density, g/m ³ , DIN EN ISO 1183	0.947
Tensile modulus of elasticity, MPa, DIN EN ISO 527	900
Shore hardness D, DIN EN ISO 868	64
Processing temperature, °C (oven temperature)*	165 – 180
Heat-up time, min/mm sheet thickness (retention time in oven)*	2 – 3

* The actual parameters can vary depending on the type and condition of the oven as well as the sheet thickness. Therefore, all figures presented here are for orientation purposes only. The exact parameters will have to be determined by the user.

Product Range

Sizes in mm	Thicknesses in mm	Colours	Antibacterial properties on request
2,000 x 1,000	2, 3, 4, 5, 6, 8, 10	natural, skin-coloured	✓

Bold type = available immediately (colour: natural);
light-faced type = available on request
The sizes specified are standard sizes.
Other sizes, thicknesses and colours available on request.

SIMONA® SIMOLIFE PE 1000

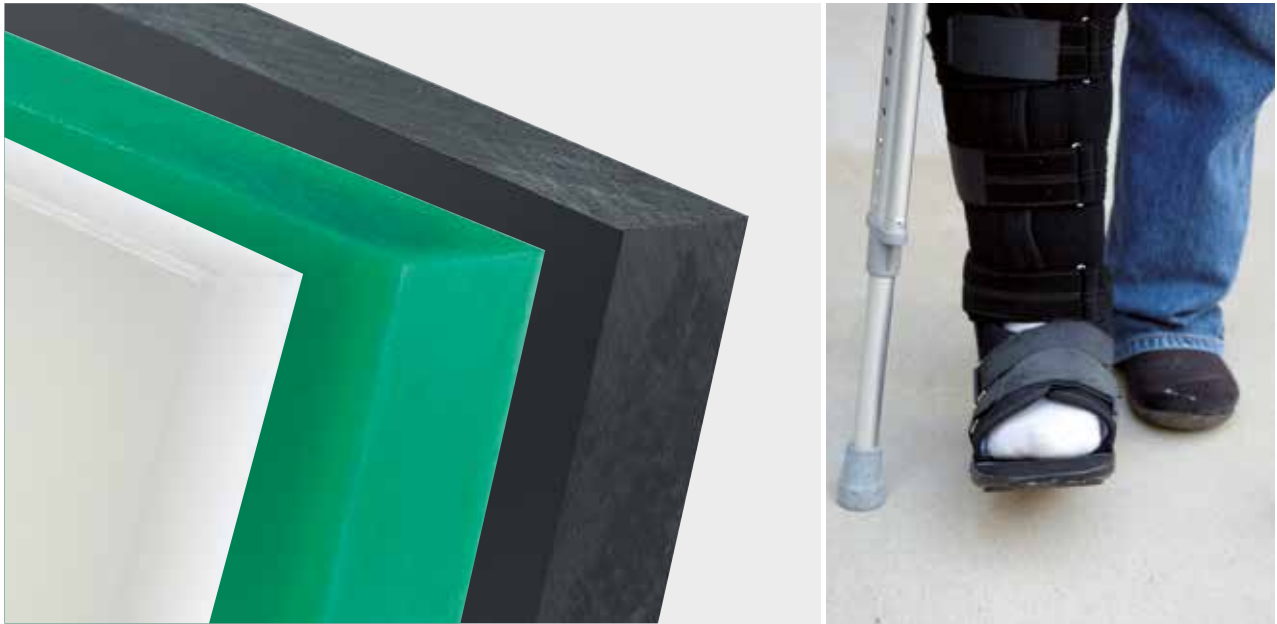

SIMONA® SIMOLIFE PE 1000

Fields of application	Description	Properties	Certifications
	Ultra-high-molecular-weight polyethylene (PE-UHMW)	High abrasion and wear resistance	Biocompatibility in accordance with DIN EN ISO 10993-5 and DIN EN ISO 10993-10
		High impact strength	
		Resistant to sweat, cosmetics, skin creams, detergents and disinfectants	Physiological safety in accordance with BfR, EU and FDA

Material specifications

Density, g/m ³ , DIN EN ISO 1183	0.930
Tensile modulus of elasticity, MPa, DIN EN ISO 527	700
Shore hardness D, DIN EN ISO 868	60
Processing temperature, °C (oven temperature)*	190 – 215
Heat-up time, min/mm sheet thickness (retention time in oven)*	3 – 4

* The actual parameters can vary depending on the type and condition of the oven as well as the sheet thickness. Therefore, all figures presented here are for orientation purposes only. The exact parameters will have to be determined by the user.

Product Range

Sizes in mm	Thicknesses in mm	Colours
2,000 x 1,000	1, 2, 3, 4, 5, 6	natural, black, green

Bold type = available immediately (colour: natural);
light-faced type = available on request
The sizes specified are standard sizes.
Other sizes, thicknesses and colours available on request.

SIMONA® SIMOLIFE PE-W



SIMONA® SIMOLIFE PE-W

Fields of application	Description	Properties	Certifications
	Plasticized polyethylene (LDPE)	Lower rigidity and strength than HDPE	Biocompatibility in accordance with DIN EN ISO 10993-5 and DIN EN ISO 10993-10
		High flexibility	
		Resistant to sweat, cosmetics, skin creams, detergents and disinfectants	Physiological safety in accordance with BfR, EU and FDA

Material specifications

Density, g/m ³ , DIN EN ISO 1183	0.928
Tensile modulus of elasticity, MPa, DIN EN ISO 527	350
Shore hardness D, DIN EN ISO 868	54
Processing temperature, °C (oven temperature)*	120 – 130
Heat-up time, min/mm sheet thickness (retention time in oven)*	2 – 3

* The actual parameters can vary depending on the type and condition of the oven as well as the sheet thickness. Therefore, all figures presented here are for orientation purposes only. The exact parameters will have to be determined by the user.

Product Range

Sizes in mm	Thicknesses in mm	Colours
2,000 x 1,000	1, 1.5, 2, 3, 4, 5, 6	natural
50,000 x 1,000	1, 1.5, 2	natural

Bold type = available immediately;
light-faced type = available on request
The sizes specified are standard sizes.
Other sizes, thicknesses and colours available on request.

SIMONA® SIMOLIFE PP-DWV



SIMONA® SIMOLIFE PP-DWV

Fields of application	Description	Properties	Certifications
	Polypropylene homopolymer	Higher rigidity and strength than PP-C	Biocompatibility in accordance with DIN EN ISO 10993-5 and DIN EN ISO 10993-10
		Fatigue stability	
		Minimal, calculable shrinkage	
		Resistant to sweat, cosmetics, skin creams, detergents and disinfectants	Physiological safety in accordance with BfR, EU and FDA

Material specifications

Density, g/m ³ , DIN EN ISO 1183	0.905
Tensile modulus of elasticity, MPa, DIN EN ISO 527	1,380
Shore hardness D, DIN EN ISO 868	70
Processing temperature, °C (oven temperature)*	185 - 215
Heat-up time, min/mm sheet thickness (retention time in oven)*	2 - 3

* The actual parameters can vary depending on the type and condition of the oven as well as the sheet thickness. Therefore, all figures presented here are for orientation purposes only. The exact parameters will have to be determined by the user.

Product Range

Sizes in mm	Thicknesses in mm	Colours	Antibacterial properties on request
2,000 x 1,000	2, 3 , 4 , 5 , 6	natural	✓

Bold type = available immediately;
light-faced type = available on request
The sizes specified are standard sizes.
Other sizes, thicknesses and colours available on request.

SIMONA® SIMOLIFE PP-C



SIMONA® SIMOLIFE PP-C

Fields of application	Description	Properties	Certifications
	Polypropylene copolymer	Higher impact strength than PP-DWV	Biocompatibility in accordance with DIN EN ISO 10993-5 and DIN EN ISO 10993-10
		Lower susceptibility to stress cracks	
		Resistant to sweat, cosmetics, skin creams, detergents and disinfectants	Physiological safety in accordance with BfR, EU and FDA

Material specifications

Density, g/m ³ , DIN EN ISO 1183	0.910
Tensile modulus of elasticity, MPa, DIN EN ISO 527	1,200
Shore hardness D, DIN EN ISO 868	67
Processing temperature, °C (oven temperature)*	185 – 215
Heat-up time, min/mm sheet thickness (retention time in oven)*	2 – 3

* The actual parameters can vary depending on the type and condition of the oven as well as the sheet thickness. Therefore, all figures presented here are for orientation purposes only. The exact parameters will have to be determined by the user.

Product Range

Sizes in mm	Thicknesses in mm	Colours
2,000 x 1,000	2, 3 , 4 , 5 , 6	natural

Bold type = available immediately;
light-faced type = available on request
The sizes specified are standard sizes.
Other sizes, thicknesses and colours available on request.

SIMONA® SIMOLIFE PETG



SIMONA® SIMOLIFE PETG

Fields of application	Description	Properties	Certifications
	Thermoplastic copolyester	Highly transparent even after processing	Biocompatibility in accordance with DIN EN ISO 10993-5 and DIN EN ISO 10993-10
		Excellent thermoforming properties	
		Good postforming properties	Physiological safety in accordance with BfR, EU and FDA

Material specifications

Density, g/m ³ , DIN EN ISO 1183	1.270
Tensile modulus of elasticity, MPa, DIN EN ISO 527	1,900
Shore hardness D, DIN EN ISO 868	78
Processing temperature, °C (oven temperature)*	160 – 170
Heat-up time, min/mm sheet thickness (retention time in oven)*	3 – 4

* The actual parameters can vary depending on the type and condition of the oven as well as the sheet thickness. Therefore, all figures presented here are for orientation purposes only. The exact parameters will have to be determined by the user.

Product Range

Sizes in mm	Thicknesses in mm	Colours	Antibacterial properties on request
400 x 400	9, 10, 12 , 15 , 20	transparent	✓
1,208 x 804	8, 9, 10, 12 , 15 , 20	transparent	✓

Bold type = available immediately;
light-faced type = available on request
The sizes specified are standard sizes.
Other sizes, thicknesses and colours available on request.

SIMONA® SIMOLIFE EVA flex

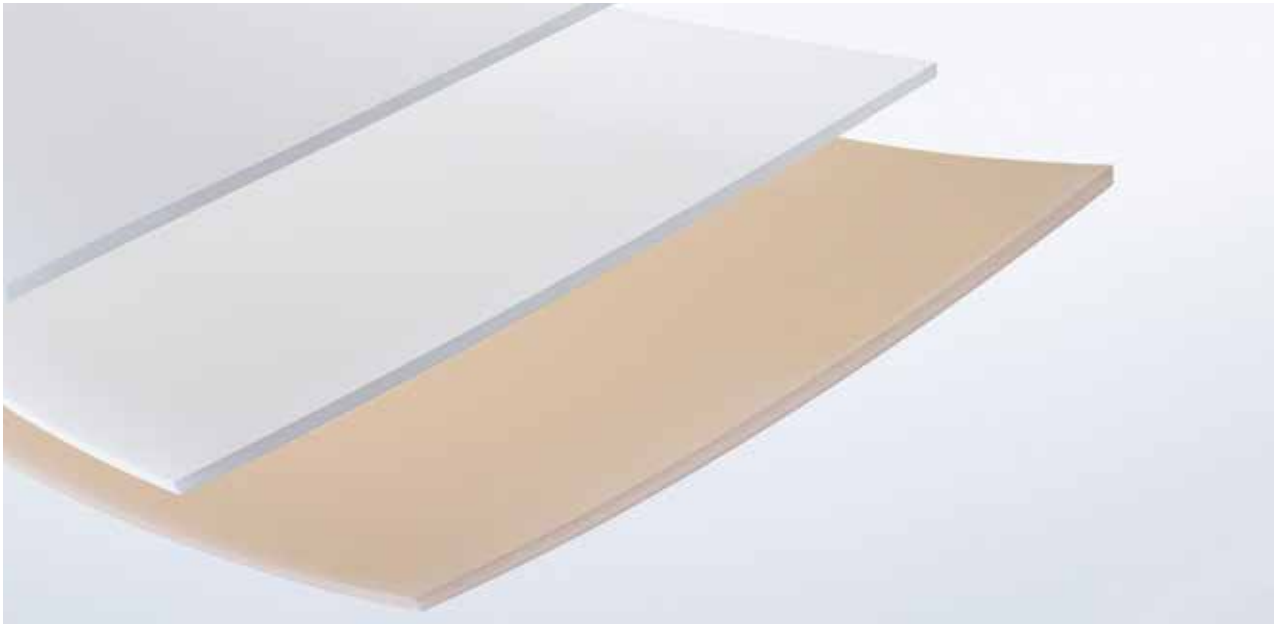

SIMONA® SIMOLIFE EVA flex

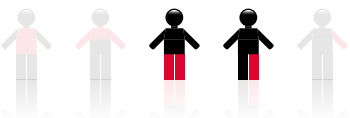
Fields of application	Description	Properties	Certifications
	Ethylene-vinyl acetate	High flexibility	Biocompatibility in accordance with DIN EN ISO 10993-5 and DIN EN ISO 10993-10
		Minimal, calculable shrinkage	Physiological safety in accordance with BfR, EU and FDA
		Excellent formability	

Material specifications

Density, g/m ³ , DIN EN ISO 1183	0.934
Tensile modulus of elasticity, MPa, DIN EN ISO 527	75
Shore hardness D, DIN EN ISO 868	39
Processing temperature, °C (oven temperature)*	150 – 160
Heat-up time, min/mm sheet thickness (retention time in oven)*	1 – 2

* The actual parameters can vary depending on the type and condition of the oven as well as the sheet thickness. Therefore, all figures presented here are for orientation purposes only. The exact parameters will have to be determined by the user.

Product Range

Sizes in mm	Thicknesses in mm	Colours	Antibacterial properties on request
400 x 400	3, 4, 6, 8, 9, 10, 12, 15	natural, skin-coloured	✓
2,000 x 1,000	3, 4, 6, 8, 9, 10, 12, 15	natural	✓

Bold type = available immediately (colour: natural);
light-faced type = available on request
The sizes specified are standard sizes.
Other sizes, thicknesses and colours available on request.

SIMONA® SIMOLIFE EVA superflex



SIMONA® SIMOLIFE EVA superflex

Fields of application	Description	Properties	Certifications
	Ethylene-vinyl acetate	Very high flexibility	Biocompatibility in accordance with DIN EN ISO 10993-5 and DIN EN ISO 10993-10
		Minimal, calculable shrinkage	
		Excellent formability	Physiological safety in accordance with BfR, EU and FDA

Material specifications

Density, g/m ³ , DIN EN ISO 1183	0.955
Tensile modulus of elasticity, MPa, DIN EN ISO 527	19
Shore hardness D, DIN EN ISO 868	29
Processing temperature, °C (oven temperature)*	150 – 160
Heat-up time, min/mm sheet thickness (retention time in oven)*	1 – 2

* The actual parameters can vary depending on the type and condition of the oven as well as the sheet thickness. Therefore, all figures presented here are for orientation purposes only. The exact parameters will have to be determined by the user.

Product Range

Sizes in mm	Thicknesses in mm	Colours
400 x 400	6, 9, 10, 12, 15	natural

Bold type = available immediately;
light-faced type = available on request
The sizes specified are standard sizes.
Other sizes, thicknesses and colours available on request.

Advice and Information

Consulting Service

Our customers benefit from customised solutions that help them compete successfully within the business arena. SIMONA can draw on many years of experience in the manufacture of sheets, pipes and fittings. You will also be able to rely on our extensive know-how and high level of technical expertise in the field of polymer engineering. Our Technical Service Centre team looks forward to assisting you:

i Phone +49(0)67 52 14-587
Fax +49(0)67 52 14-302
tsc@simona.de

SIMONA Sales Academy

We organise seminars at our Technology Centre and educational facilities in Kirn for the purpose of providing product training and information on the very latest processing and fabrication methods. On request, we can also provide training at your own premises. Contact details:

i Phone +49(0)67 52 14-251
Fax +49(0)67 52 14-60251
salesacademy@simona.de

Information Service

Further information is available in the form of catalogues, brochures, case studies and project reports. We also offer DVDs, technical data sheets and product samples. Please feel free to contact our Marketing department:

i Phone +49(0)67 52 14-383
Fax +49(0)67 52 14-738
marketing@simona.de

Delivery Service

Our central warehouse and global distribution centres supply SIMONA standard products from stock, thus guaranteeing speedy and flexible delivery. Various sizes and thicknesses available from stock. Please contact our sales department for further details concerning availability.

i Phone +49(0)67 52 14-0
Fax +49(0)67 52 14-211
sales@simona.de





SIMONA worldwide

SIMONA AG

Teichweg 16 55606 Kirn

Germany

Phone +49 (0) 67 52 14-0

Fax +49 (0) 67 52 14-211

mail@simona.de

www.simona.de

PRODUCTION SITES

Plant I

Teichweg 16

55606 Kirn

Germany

Plant II

Sulzbacher Straße 77

55606 Kirn

Germany

Plant III

Gewerbestraße 1-2

77975 Ringsheim

Germany

SIMONA Plast-Technik s.r.o.

U Autodílen 23

43603 Litvínov-Chudeřín

Czech Republic

SIMONA ENGINEERING PLASTICS (Guangdong) Co. Ltd.

No. 368 Jinou Road

High & New Technology Industrial

Development Zone

Jiangmen, Guangdong

China 529000

SIMONA AMERICA INC.

64 N. Conahan Drive

Hazleton, PA 18201

USA

SALES OFFICES

SIMONA S.A.S. FRANCE

Z.I. 1, rue du Plant Loger

95335 Domont Cedex

France

Phone +33 (0) 1 39 35 49 49

Fax +33 (0) 1 39 91 05 58

mail@simona-fr.com

www.simona-fr.com

SIMONA UK LIMITED

Telford Drive

Brookmead Industrial Park

Stafford ST16 3ST

Great Britain

Phone +44 (0) 1785 22 24 44

Fax +44 (0) 1785 22 20 80

mail@simona-uk.com

www.simona-uk.com

SIMONA AG SWITZERLAND

Industriezone

Bäumlimattstrasse 16

4313 Möhlin

Switzerland

Phone +41 (0) 61 855 9070

Fax +41 (0) 61 855 9075

mail@simona-ch.com

www.simona-ch.com

SIMONA S.r.l. ITALIA UNIPERSONALE

Via Padana Superiore 19/B

20090 Vimodrone (MI)

Italy

Phone +39 02 25 08 51

Fax +39 02 25 08 520

mail@simona-it.com

www.simona-it.com

SIMONA IBERICA SEMIELABORADOS S.L.

Doctor Josep Castells, 26-30

Polígono Industrial Fonollar

08830 Sant Boi de Llobregat

Spain

Phone +34 93 635 4103

Fax +34 93 630 8890

mail@simona-es.com

www.simona-es.com

SIMONA-PLASTICS CZ, s.r.o.

Zděbradská ul. 70

25101 Říčany-Jažlovice

Czech Republic

Phone +420 323 63 78 3-7/-8/-9

Fax +420 323 63 78 48

mail@simona-cz.com

www.simona-cz.com

SIMONA POLSKA Sp. z o.o.

ul. Wrocławska 36

Wojkowice k / Wrocławia

55-020 Żórawina

Poland

Phone +48 (0) 71 352 80 20

Fax +48 (0) 71 352 81 40

mail@simona-pl.com

www.simona-pl.com

OOO "SIMONA RUS"

Prospekt Andropova, 18, Bl. 6

115432 Moscow

Russian Federation

Phone +7 (499) 683 00 41

Fax +7 (499) 683 00 42

mail@simona-ru.com

www.simona-ru.com

SIMONA FAR EAST LIMITED

Room 501, 5/F

CCT Telecom Building

11 Wo Shing Street

Fo Tan, Hong Kong

China

Phone +852 2947 0193

Fax +852 2947 0198

sales@simona-hk.com

www.simona-cn.com

SIMONA ENGINEERING PLASTICS TRADING (Shanghai) Co. Ltd.

Room C, 19/F, Block A

Jia Fa Mansion

129 Da Tian Road, Jing An District

Shanghai

China 200041

Phone +86 21 6267 0881

Fax +86 21 6267 0885

shanghai@simona.com.cn

www.simona-cn.com

SIMONA AMERICA INC.

64 N. Conahan Drive

Hazleton, PA 18201

USA

Phone +1 866 501 2992

Fax +1 800 522 4857

mail@simona-america.com

www.simona-america.com



SIMONA AG

Teichweg 16

D-55606 Kirn

Phone +49 (0) 67 52 14-0

Fax +49 (0) 67 52 14-211

mail@simona.de

www.simona.de



09/2013 - 09/13 - 1000 - GB - KD

Printed on Hello Fat matt by Deutsche Papier.